



# **BUILDING FOR SUCCESS**

*Prevailing Wage: Tollway Contract Compliance*

Presented by Illinois Tollway Contract Compliance  
November 10, 2025



**Please remain  
muted for the  
duration of the  
webinar**

**Questions can be  
submitted via the  
chat box and will be  
answered during the  
Q&A portion**



# HOUSEKEEPING RULES

# WELCOME AND INTRODUCTIONS

## *Illinois Tollway Prevailing Wage*

**Presented by: Illinois Tollway Deputy Chief of Contract Compliance Sainey Jobe and Contract Compliance Manager Graciela Perez**

A photograph of a construction site. In the foreground, a worker in a grey plaid shirt, orange safety vest, and white boots stands on a grid of steel rebar. To the right, another worker in a bright green safety vest and yellow boots is using a tool. The background shows a large red steel truss structure under construction against a blue sky with light clouds.

# ILLINOIS TOLLWAY

*Prevailing Wage:  
Tollway Contract Compliance*

November 10, 2025



# BACKGROUND



## Tollway's Commitment

- Payment of no less than the general **prevailing hourly rate** paid for work of a similar character in the **locality** in which the work is performed
- Pursuant to the State of **a Illinois' Prevailing Wage Act (PWA), 820 ILCS 130/0.01, et seq.**



# WAGE STIPULATIONS

All contractors and subcontractors rendering services under a contract that calls for the construction of a “public work,” within the meaning of the Illinois Prevailing Wage Act, 820 ILCS 130/.01 et seq. (“the Act”) **must comply with all requirements of the Act, including but not limited to, all wage requirements, notices and record keeping duties.**



# CONTRACTORS' RESPONSIBILITY



- Subcontractors and lower tiered subcontractors
- Accurately documenting and reporting for all contracts subject to the PWA
- Rates
- Construction Site



# PREVAILING WAGE RATES

## Website:

- <https://labor.illinois.gov/>

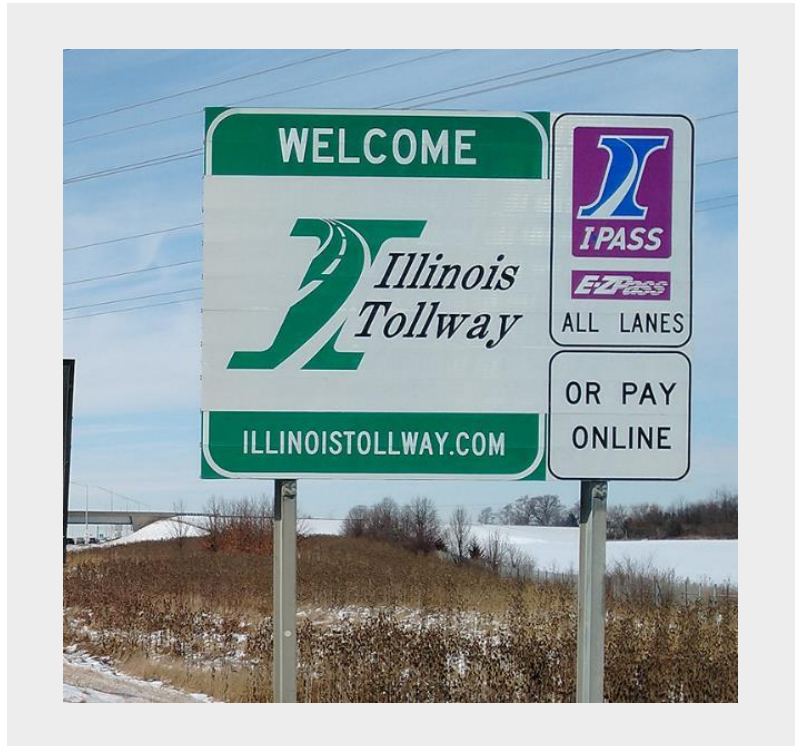

A screenshot of the Illinois Department of Labor website page for Current Prevailing Rates. The page title is "Current Prevailing Rates" and the URL is "https://labor.illinois.gov/laws-rules/conmed/current-prevailing-rates.html". The page content includes a navigation menu with "Laws and Rules" and "Conciliation and Mediation Division". The main content area features a heading "Current Prevailing Rates" followed by a paragraph explaining that the rate schedules contain the prevailing wage rates required to be paid for work performed on or after September 15, 2025, on public works projects in each County. A link "(Click here to see archived rates)" is provided. Below this, a list of counties is shown: Adams County, Alexander County, Bond County, Boone County, Brown County, Bureau County, Calhoun County, and Carroll County. A sidebar on the left lists various labor laws and rules, including "Equal Pay Registration Certificate (EPRC)", "Certified Transcript of Payroll", "Child Care Act of 1969", "Current Prevailing Rates", "ECA Reporting Requirement Submission", and "Employee".





# PREVAILING WAGE RATES – CONT'D

Cook County Prevailing Wage Rates posted on 9/15/2025

Trade Title	Rg	Type	C	Base	Foreman	Overtime					Pension	Vac	Trng	Other Ins	Add OT 1.5x owed	Add OT 2.0x owed
						M-F	Sa	Su	Hol	H/W						
ASBESTOS ABT-GEN	All	ALL		51.40	52.40	1.5	1.5	2.0	2.0	18.32	17.71	0.00	0.91	0.00	0.00	0.00
ASBESTOS ABT-MEC	All	BLD		42.02	45.38	1.5	1.5	2.0	2.0	16.44	16.64	0.00	0.92		3.37	6.73
BOILERMAKER	All	BLD		58.91	64.21	2.0	2.0	2.0	2.0	7.07	27.02	0.00	3.69	2.31	0.00	39.30
BRICK MASON	All	BLD		53.06	58.37	1.5	1.5	2.0	2.0	12.95	26.26	0.00	1.57	0.00	4.23	8.45
CARPENTER	All	ALL		56.71	58.71	1.5	1.5	2.0	2.0	13.64	27.26	2.61	1.04		0.00	0.00
CEMENT MASON	All	ALL		53.10	55.10	2.0	1.5	2.0	2.0	18.43	24.00	0.00	1.25		2.50	5.00
CERAMIC TILE FINISHER	All	BLD		49.09	49.09	1.5	1.5	2.0	2.0	13.25	17.61	0.00	1.37	0.00	5.57	11.14
CERAMIC TILE LAYER	All	BLD		57.04	62.04	1.5	1.5	2.0	2.0	13.25	21.60	0.00	1.50	0.00	7.63	15.26
COMMUNICATION ELECTRICIAN	All	BLD		51.14	56.25	1.5	1.5	2.0	2.0	16.70	14.48	1.40	1.27	0.10	0.00	0.00
ELECTRIC PWR EQMT OP	All	ALL		64.58	70.87	1.5	1.5	2.0	2.0	12.99	22.45	0.00	3.66	0.00	0.00	0.00
ELECTRIC PWR GRNDMAN	All	ALL		50.37	70.87	1.5	1.5	2.0	2.0	10.13	17.51	0.00	2.85	0.00	0.00	0.00
ELECTRIC PWR LINEMAN	All	ALL		64.58	70.87	1.5	1.5	2.0	2.0	12.99	22.45	0.00	3.66	0.00	0.00	0.00
ELECTRICIAN	All	ALL		57.75	63.53	1.5	1.5	2.0	2.0	19.34	21.13	1.60	1.87	0.30	0.00	0.00
ELEVATOR CONSTRUCTOR	All	BLD		70.68	79.52	2.0	2.0	2.0	2.0	16.28	21.36	5.65	0.80		0.00	0.00
FENCE ERECTOR	All	ALL		52.25	54.75	1.5	1.5	2.0	2.0	14.29	19.02	0.00	1.00	0.00	0.00	0.00
GLAZIER	All	BLD		53.55	55.05	1.5	2.0	2.0	2.0	16.04	26.64	0.00	2.30	0.00	0.00	0.00
HEAT/FROST INSULATOR	All	BLD		56.02	59.38	1.5	1.5	2.0	2.0	16.44	19.88	0.00	0.92		4.99	9.97
IRON WORKER	All	ALL		62.46	65.96	2.0	2.0	2.0	2.0	19.05	27.04	0.00	0.49	0.00	0.00	0.00
LABORER	All	ALL		51.40	52.15	1.5	1.5	2.0	2.0	18.32	17.71	0.00	0.91	0.00	0.00	0.00
LATHER	All	ALL		56.71	58.71	1.5	1.5	2.0	2.0	13.64	27.26	2.61	1.04		0.00	0.00
MACHINIST	All	BLD		60.39	64.39	1.5	1.5	2.0	2.0	11.43	9.95	1.85	1.47	0.00	0.00	0.00
MARBLE FINISHER	All	ALL		40.21	54.60	1.5	1.5	2.0	2.0	12.95	23.81	0.00	0.98	0.00	3.00	6.00
MARBLE SETTER	All	BLD		52.00	57.20	1.5	1.5	2.0	2.0	12.95	25.57	0.00	1.25	0.00	3.88	7.76
MATERIAL TESTER I	All	ALL		41.40		1.5	1.5	2.0	2.0	18.32	17.71	0.00	0.91	0.00	0.00	0.00
MATERIALS TESTER II	All	ALL		46.40		1.5	1.5	2.0	2.0	18.32	17.71	0.00	0.91	0.00	0.00	0.00
MILLWRIGHT	All	ALL		56.71	58.71	1.5	1.5	2.0	2.0	13.64	27.26	2.61	1.04		0.00	0.00



### Legend

**Rg** Region

**Type** Trade Type - All,Highway,Building,Floating,Oil & Chip,Rivers

**C** Class

**Base** Base Wage Rate

**OT M-F** Unless otherwise noted, OT pay is required for any hour greater than 8 worked each day, Mon through Fri. The number listed is the multiple of the base wage.

**OT Sa** Overtime pay required for every hour worked on Saturdays

**OT Su** Overtime pay required for every hour worked on Sundays

**OT Hol** Overtime pay required for every hour worked on Holidays

**H/W** Health/Welfare benefit

**Vac** Vacation

**Trng** Training

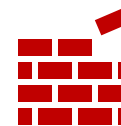

# SUMMARY

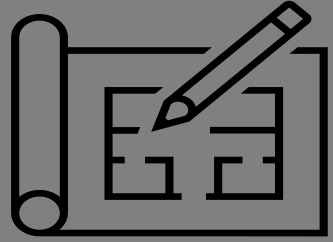

- ISTHA's Construction Contracts are subject to **the Illinois Prevailing Wage Act, 820 ILCS 130/01 et seq. ("the Act")**.
- Illinois Department of Labor publishes the prevailing wage rates on its website <https://www.illinois.gov/idol/Laws-Rules/CONMED/Pages/Rates.aspx>. The Illinois Department of Labor revises the prevailing wage rates and **the contractor/subcontractor has an obligation to check the Illinois Department of Labor's website for revisions to prevailing wage rates**.
- **All** contractors and subcontractors rendering construction work must comply with all requirements of the Act including but not limited to all wage requirements, notices, and record keeping duties.



- Vendor is responsible for contacting **the Illinois Department of Labor**.
- Tollway's LCPtracker payroll reporting and monitoring system requires **weekly reporting of certified payroll**.
- Contractors are required to respond within **48 hours** of receiving a penalty form ISTHA's Contract Compliance Team.

## SUMMARY – CONT'D





# SUMMARY – CONT'D

- Penalty Reports must be resolved within **7 – 14 calendars days**.
- ISTHA's Contract Compliance Team will permit edit to update certified payroll information upon receipt of **supporting documents**.
- **Contractors and subcontractors** are required to report certified payroll to IDOL by accessing the Certified Transcript of Payroll Portal at:

<https://labor.illinois.gov/laws-rules/conmed/certifiedtranscriptofpayroll.html>





# CONTRACT COMPLIANCE - CONTACT

Assigned Contract Compliance Analyst and/or [contractcompliance@getipass.com](mailto:contractcompliance@getipass.com)

Grace Perez, Contract Compliance Manager

- [gperez@getipass.com](mailto:gperez@getipass.com)

Sainey Jobe, Deputy Chief of Contract Compliance

- [sjobe@getipass.com](mailto:sjobe@getipass.com)





**QUESTIONS**

# DIVERSITY AND STRATEGIC DEVELOPMENT

## PROGRAMS

- Business assistance
- Mentoring and training
- Construction industry training and hiring opportunities

## INITIATIVES

- Virtual outreach sessions
- Training webinars
- Contracting opportunity emails

## REGISTER FOR TOLLWAY DIVERSITY ALERTS!

[lperez@getipass.com](mailto:lperez@getipass.com)

Presented on November 10, 2025



The screenshot shows the Illinois Tollway website's Diversity and Strategic Development page. At the top, there is a navigation bar with the Illinois Tollway logo, a menu icon, and a search icon. Below the navigation bar, the breadcrumb trail reads "Doing Business > Diversity > Diversity Overview". The main heading is "Diversity And Strategic Development". Below the heading, there is a paragraph of text: "The Illinois Tollway Department of Diversity and Strategic Development is a driving force for increasing economic opportunities in the diverse communities we serve." At the bottom of the screenshot, there is a video player showing a group of diverse people smiling, with a red play button in the center. The video title is "Illinois Tollway Depart...".



@ILTollway



@ILTollway



@Illinois Tollway



@ILTollway



@ILTollway

# SOCIAL MEDIA





**THANK YOU**

