



ILLINOIS TOLLWAY NEWS

FOR IMMEDIATE RELEASE
September 3, 2024

NEW LANE OPENING ON CENTRAL TRI-STATE TOLLWAY (I-294) BETWEEN IRVING PARK ROAD AND NORTH AVENUE PROVIDING FIVE LANES FOR SOUTHBOUND TRAVEL

Traffic between Roosevelt Road and Irving Park Road scheduled to begin shifting this week

DOWNERS GROVE, IL – The Illinois Tollway is scheduled to open a new fifth lane for drivers on the southbound Tri-State Tollway (I-294) between Irving Park Road and North Avenue next week, marking the completion of major construction work between Balmoral Avenue and North Avenue on the Central Tri-State Tollway Project.

“We hope customers will see the benefit of the Central Tri-State Tollway Project as we begin to turn the new roadway back over to drivers,” said Illinois Tollway Executive Director Cassandra Rouse. “While our work is not yet completed, we understand the inconvenience roadwork can cause, and we want to take this opportunity to say thank you for your patience.”

Beginning overnight tonight, September 3, and continuing nightly through the week, work is scheduled to shift traffic onto newly constructed pavement on I-294 between North Avenue and Wolf Road and prepare for the opening of the new fifth southbound lane.

The nightly lane closures will be scheduled in both directions as needed between 7 p.m. and 5 a.m. the following morning. Up-to-date closure information will be posted on the Tollway website in the [Daily Construction Alert](#).

Between North Avenue and Wolf Road, the northbound I-294 counterflow lanes will be removed and northbound traffic shifted to the right onto newly completed pavement.

Between Roosevelt Road and St. Charles Road, two right lanes of northbound I-294 will be shifted to the left with the two far left lanes remaining in a counterflow configuration on the southbound side to provide a work zone to complete pavement reconstruction.

Then, overnight Sunday, September 8 into Monday, September 9, on southbound I-294 a new lane will open, providing five lanes for southbound traffic between Irving Park Road and North Avenue on new pavement.

Electronic message signs and construction signage will be put in place in advance to alert drivers of the changes. Work to shift traffic will take place during overnight and off-peak daytime hours to minimize the impact on drivers. All work is weather dependent.

Once the traffic shifts are complete, some minor work is scheduled to continue through the end of the year north of North Avenue with occasional lane closures in order to complete all work. A new fifth northbound lane between Balmoral Avenue and North Avenue is expected to open to traffic later this year.

Construction in this area is being coordinated the Illinois Department of Transportation, Cook County, DuPage County, City of Elmhurst, City of Northlake, Village of Berkeley, Village of Oak Brook and the Village of Franklin Park, as well as local fire and police departments.

-more-

As part of the Tollway's \$4 billion the Central Tri-State Tollway (I-294) Project, work in this northern section between Balmoral Avenue and North Avenue began in June 2018 and is scheduled to be complete by the end of 2024 and has included reconstructing, resurfacing and widening of the I-294 mainline roadway from four to five lanes along with improvements to bridges and ramps, as well as reconstructing the inside shoulders to provide Flex Lanes.

Work in this section of the Tri-State Tollway also includes ongoing construction of the new I-490/I-294 Interchange with two new ramp bridges that will provide access for the new I-490 Tollway and a new southbound exit ramp from I-294 to County Line Road between Grand Avenue and North Avenue. Improvements as part of this project also include guardrail, drainage, lighting and signage installation, as well as landscaping improvements.

Construction updates, project information, maps and detour information for work that is part of the I-490/I-294 Interchange Project and the Central Tri-State Tollway (I-294) Project are available in the Projects section on the Tollway's website at www.illinoistollway.com.

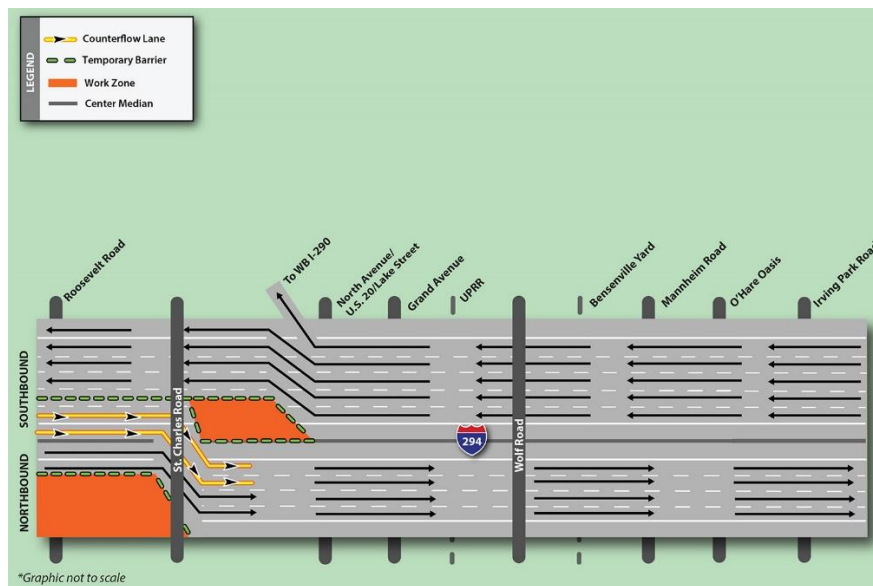

Work Zone Safety

Construction zone speed limits are in effect in all construction zones 24/7 and drivers should continue to watch for changing traffic patterns and use caution, especially when workers are present. On I-294, a 45 mph work zone speed limit is in effect throughout the construction season.

The Illinois Tollway reminds motorists that the "Move Over Law" requires motorists to change lanes or to slow down and proceed with caution when passing any vehicle on the side of the road with hazard lights activated. If you see flashing lights ahead, please move over or slow down.

Illinois State Police have zero tolerance for drivers speeding in work zones or failure to comply with the Move Over Law. The minimum penalty for speeding in a work zone is \$250 with up to a \$25,000 fine and a 14-year jail sentence for hitting a roadway worker. Penalties for failure to slow down or move over for a vehicle on the shoulder with flashing lights includes up to a \$10,000 fine, 2-year suspension of driving privileges and jail time, in extreme cases.

About Move Illinois

The Illinois Tollway's 15-year, \$14 billion capital program, *Move Illinois: The Illinois Tollway Driving the Future*, is improving mobility, relieving congestion, reducing pollution, creating as many as 152,000 jobs and linking economies throughout the region. The first 11 years of *Move Illinois* are on schedule and within budget, delivering the rebuilt and widened Jane Addams Memorial Tollway (I-90) as a state-of-the-art 21st century corridor and opening a new interchange connecting the Tri-State Tollway (I-294) to I-57. Progress continues on projects addressing the remaining needs of the existing Tollway system, delivering the Elgin O'Hare Western Access Project and reconstruction of the Central Tri-State Tollway (I-294).

About the Illinois Tollway

The Illinois Tollway is a user-fee system that receives no state or federal funds for maintenance and operations. The agency maintains and operates 294 miles of roadways in 12 counties in Northern Illinois, including the Reagan Memorial Tollway (I-88), the Veterans Memorial Tollway (I-355), the Jane Addams Memorial Tollway (I-90), the Tri-State Tollway (I-94/I-294/I-80) and the Illinois Route 390 Tollway.

#